



**AQUATHERM**<sup>TM</sup>

HOT WATER SUIT

CATEGORY B HOT WATER SUIT

Instruction Manual



[www.hotwatersuit.com](http://www.hotwatersuit.com)

Version 1.3/122020 **PATENT PENDING**

Page 1

## Contents

Warnings	3	Donning the Suit	8
Medical Advice	4	Doffing the Suit	8
Type of Suit	5	Cleaning & Care	9
Material	5	Storage	9
Valve	6	Maintenance	10
Tube Assembly	6	Inspection Intervals	10
Compatibility	6	Repairs	10
Suitability	6	Modifications	10
Suit Fitting	7	Safe Disposal	11
Size Chart	7	Recycling	11
Accessories	7	Manufacturer Information	12
Components Supplied	7	Warranty	12
Suit Checks	8	Caveat	12

## Translation / Languages

If this product is to be sold to countries where English is not the first language, please contact O'Three Ltd where a translated version of the user hand book will be provided.

## Warnings



**Instructions** - Please read all the instructions in this manual prior to using the Aquatherm™ suit.



**Training** - This suit is only to be used by an individual who has obtained specific training in its use, or is under the instruction of an industry recognised instructor.



**Buoyancy** - This suit is not intended as a buoyancy aid. The buoyancy of the Aquatherm™ suit will decrease with depth.

## Medical Advice



**Allergies** - In very rare cases some people may have an allergic reaction to some kinds of neoprene or latex.

If a rash of any kind does appear whilst you are wearing your suit, please remove immediately and seek medical advice.



**Scalding** - Although incredibly rare, scalding may occur.

To help minimise the effects of scalding it is advisable to wear an undergarment or base layer under any hot water suit.



**Work Rates** - If an increased work rate is expected whilst using the Aquatherm™, please be aware of any signs of hyperthermia (over heating) and take immediate action.

## Type of Suit

Aquatherm™ - Commercial Diving Hot Water Suit.

The suit is fully compliant with CE standard EN 14225-3:2017

## Declaration of Conformity

The Declaration of conformity can be viewed at our website: [www.hotwatersuit.com](http://www.hotwatersuit.com)

## Material

2.5mm pre-compressed, shrink resistant neoprene.

Externally laminated with a tough triple thread nylon.

Resin impregnated for quick drying and increased durability.

## Features

- Neck comfort.
- Moulded knee and shoulder pads.
- Off-set zip.
- Detachable / reusable hot water inlet valve.
- Wrist / ankle velcro mounts.
- 2 x Reinforced cargo pockets.
- Ergonomically shaped at the arms and legs.
- Glued and blind stitched.
- Internally reinforced and sealed seams.

## Compatibility

The Aquatherm™ is compatible with all commercial diving hot water systems and all commercial diving harness systems.

The Aquatherm™ can be used by male or female divers if sizing allows.

## Suitability

The Aquatherm™ is designed to be used as a commercial hot water suit attached to commercial hot water delivery systems.

The suit is designed to be used in an environmental temperature range of 2°C (35.6°F) to 20°C (68°F)

## Tube Assembly

Continuous loop system and an internal bore that is 100% larger than the industry standard means an increased efficiency in the delivery of hot water throughout the entire suit, giving a flow of up to 45 Ltrs. per minute.

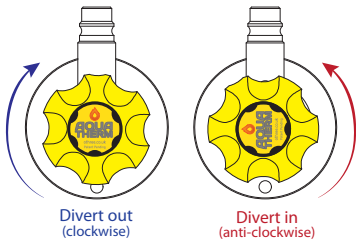

## Valve

Re-useable, quick fit 'in and out' valve assembly for easy maintenance.



## Suit Fitting

The suit has its size designation printed on both arms and inside on the suit information panel.

Please choose a suit that most closely matches your body dimensions - height and chest.

## Size Chart

Product Code	Sizes	Height	Chest
JP014 Aquatherm - S		5'5" - 5'7" / 165 - 170cm	36" - 38" / 92 - 97cm
JP000 Aquatherm - M		5'7" - 5'9" / 170 - 175cm	38" - 40" / 97 - 101cm
JP001 Aquatherm - MT		5'9" - 5'11" / 175 - 180cm	38" - 40" / 97 - 101cm
JP002 Aquatherm - ML		5'9" - 5'11" / 175 - 180cm	40" - 42" / 101 - 107cm
JP003 Aquatherm - L		5'11" - 6'1" / 180 - 185cm	42" - 44" / 107 - 112cm
JP004 Aquatherm - LT		6'1" - 6'3" / 185 - 190cm	42" - 44" / 107 - 112cm
JP005 Aquatherm - XL		6'1" - 6'3" / 185 - 190cm	44" - 46" / 112 - 117cm
JP006 Aquatherm - XLT		6'3" - 6'5" / 190 - 195cm	44" - 46" / 112 - 117cm
JP007 Aquatherm - 2XL		6'3" - 6'5" / 190 - 195cm	46" - 48" / 117 - 122cm
JP008 Aquatherm - 2XLT		6'5" - 6'7" / 195 - 201cm	46" - 48" / 117 - 122cm
JP009 Aquatherm - 3XL		6'5" - 6'7" / 195 - 201cm	48" - 50" / 122 - 127cm

## Accessories / Spares

Please visit our website at [www.hotwatersuit.com](http://www.hotwatersuit.com) for a full list of accessories and spares.

## Components Supplied:

- Neoprene Hot Water Suit
- Instruction Manual
- Valve Tightening Spanner

## Suit Checks

### *Prior to use*

- Zip is operable and in good condition.
- Valve is seated tightly into suit.
- We recommend a full flow test prior to every dive.

### *Post dive*

- Check to make sure the suit has no tears or wear from use.
- Check if the suit has picked up any dirt or contamination that will degrade it.
- Clean the suit as per instructions in this manual.

## Donning the Suit

1. Treat the suit as you would a set of overalls.
2. Undo the front zip, pull onto your legs and up to your waist.
3. Pull onto your left arm first, then the right and then pull up the front zip.

## Doffing the suit

1. Treat the suit as you would a set of overalls.
2. The doffing procedure is the reverse of donning.
3. Undo the front zip, pull the suit off your right then left arm.
4. Push the suit down to the waist and step out of the legs.



## Cleaning



Rinse thoroughly in cold fresh water after every use.



Allow to dry naturally and out of direct sunlight.



Occasionally wash in a mild detergent.



Periodically apply silicone spray to the zip.

## Care Instructions



HAND  
WASH



DO NOT  
IRON



DO NOT  
DRY CLEAN

## Storage

After rinsing hang the suit on a curved hanger.

Do not leave a neoprene suit folded in a damp condition for longer than is necessary.

Neoprene will crease if not stored correctly.

## Diesel and Oil

You may come in contact with diesel. This will have a massive impact on the life of the suit.

Diesel and oil will eat your suit. We cannot offer a warranty / guarantee against this. Regular rinsing in fresh water will help slow this process down.

## Maintenance

### *Suit Maintenance*

Please follow the cleaning and inspection routines as detailed in this manual.

### *Valve / Loop Maintenance*

Periodically flush the valve and tubes through with clean fresh water.

In order to carry out this procedure it is not necessary to remove the valve from the suit.

## Inspection Intervals

The suit should be inspected by a responsible person prior and post every dive.

If the suit is stored for any length of time the suit should be thoroughly checked and flow tested prior to re-commissioning and use.

## Repairs

Simple repairs to the suit may be carried out with a quality neoprene adhesive.

## Modifications

Under no circumstances should the suit be modified without the knowledge and consent of the manufacturer.

## Safe Disposal

When a suit has reached the end of its natural life, the correct method of disposal will depend on the laws and regulations within your country.

Please ensure you dispose of this suit in a thoughtful and careful way.

For suits that may have become contaminated with chemicals, additional expert advice should be sought.

Before disposal, as an additional safety measure, we advise you cut the suit in half.

## Recycling



**Please be aware that the suit valve is easy to remove and therefore re-useable.**

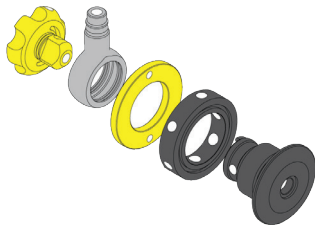

This is a unique feature of the Aquatherm™ Hot Water Suit.

Recycling part of the suit at end of life is not only better for the environment but allows for a cost saving in equipment purchase.

## Manufactured by:



O'Three Ltd  
Osprey Quay  
Portland, Dorset UK  
DT5 1BL



+44 (0) 1305 822820



sales@hotwatersuit.com

## Warranty

The Aquatherm™ is guaranteed against defects in materials and workmanship for one year. In the unlikely event you do experience a problem during that period, if after inspection, O'Three are satisfied that the product is defective, and taking into account what they regard as fair wear and tear from the natural life of the suit, they will repair or replace it free of charge.

## Distributed by:

Chambers Oceanics Ltd  
Harpings Road  
Hull, UK  
HU5 4JF

+44 (0) 1482 876999

sales@chambersoceanics.com

## Caveat

Regardless of where you have bought your Aquatherm™ or where you intend to use it, it is sold to you on the understanding that only English Law applies in cases of all warranty claims and product liability.



PPE Regulation (EU) 2016/425

Certificate number OT/15/744/11/2706

Fleetwood Notified Body,  
Fleetwood Nautical Campus,  
Broadwater, Fleetwood, Lancashire  
FY7 8JZ. CE 0514